

SPIROL®

COILED SPRING PINS FOR COSMETIC CASE HINGES

SPIROL® Series 550 Cosmetic Coiled Pins

The unique flexibility of the Series 550 Cosmetic Coiled Pin makes it the ideal hinge pin for compact cases.

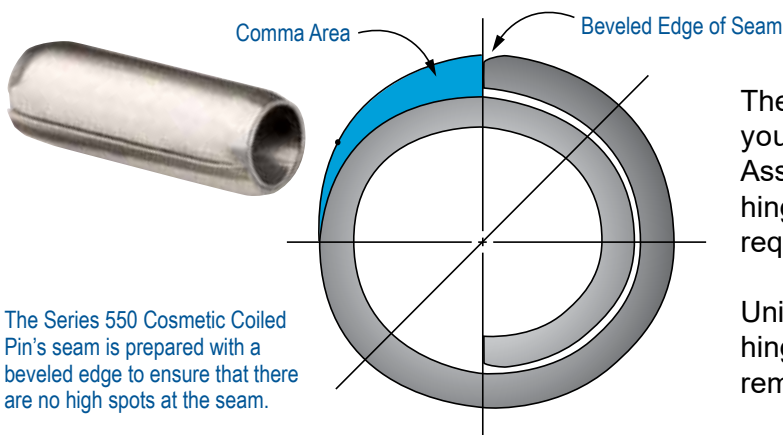

The use of a Cosmetic Coiled Pin will simplify your design and manufacturing process. Assembly is easier and less expensive, and the hinge performance will exceed swing torque requirements.

Uniform radial spring force results in controlled hinge movement and a hinge quality that remains consistent over time.

Controlled hinge movement is achieved with wider tolerances and lower molding costs than with a solid pin or cut wire.

Low insertion force and compression of the pin during installation minimize hinge stress and scrap.

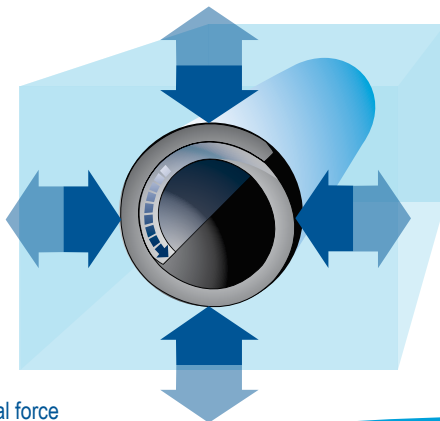

Constant radial force

Contact **SPIROL** for design assistance:
uk.SPIROL.com/Cosmetic-Design

Specifications

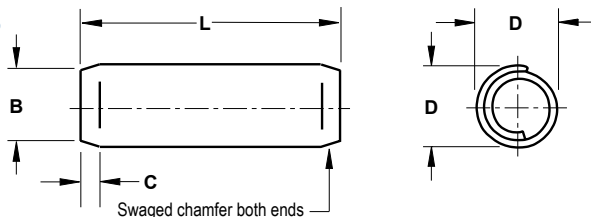

Nominal Diameter	Dim. "D" Pin Diameter		Dim. "B" Chamfer Diameter	Dim. "C" Chamfer Length	Recommended Hole Diameter		Dim. "L" Standard Lengths (Tolerance = ± 0.25)					
	Min.	Max.	Max.	(Ref.)	Min.	Max.	6	8	10	12	14	16
1.2	1.27	1.35	1.15	0.40	1.19	1.22						
1.5	1.60	1.68	1.40	0.50	1.49	1.53						

Standard Material Nickel Stainless Steel SAE 302/304, 1.4310 (18-8) **Standard Finish** Plain - Oil Free

Design Guidelines

The use of a Series 550 Cosmetic Coiled Pin will simplify design as misalignment of the inner and outer holes to provide friction is no longer necessary. Intentional misalignment is difficult to control in production and induces stress in the hinge area causing cracking and pin fallout.

- Misalignment should not exceed 0.05mm.
- 60% or more pin length retained by the inner hole.
- Minimum bearing surface in either hole should exceed three times the diameter of the pin.
- The inner hole depth should be at least 0.35mm deeper than the retained pin length to prevent breaks at assembly.
- The holes in the cover and the base should be precision matched to achieve maximum friction swing torque.

Pin Installation Technology

The **Model HC, Horizontal, Dual Pin Inserter** was developed specifically for installing Series 550 Cosmetic Coiled Pins into plastic hinges.

This machine dramatically increases production efficiency with minimal operator training and effort.



SPIROL offers complimentary Application Engineering support! We will assist on new designs as well as help resolve issues, and recommend cost savings on existing designs. Let us help by visiting [Application Engineering Services](#) on [SPIROL.co.uk](#).

Europe **SPIROL United Kingdom**
17 Princewood Road
Corby, Northants
NN17 4ET United Kingdom
Tel: +44 (0) 1536 444800
Fax: +44 (0) 1536 203415

SPIROL France
Cit  de l'Automobile ZAC Croix Blandin
18 Rue L na Bernstein
51100 Reims, France
Tel: +33 (0) 3 26 36 31 42
Fax: +33 (0) 3 26 09 19 76

SPIROL Germany
Ottostr. 4
80333 Munich, Germany
Tel: +49 (0) 89 4 111 905 71
Fax: +49 (0) 89 4 111 905 72

SPIROL Spain
Plantas 3 i 4
Gran Via de Carles III, 84
08028, Barcelona, Spain
Tel/Fax: +34 932 71 64 28

SPIROL Czech Republic
Pra sk  1847
274 01 Slan y
Czech Republic
Tel/Fax: +420 313 562 283

SPIROL Poland
ul. Solec 38 lok. 10
00-394, Warszawa, Poland
Tel. +48 510 039 345

Americas **SPIROL International Corporation**
30 Rock Avenue
Danielson, Connecticut 06239 U.S.A.
Tel. +1 860 774 8571
Fax. +1 860 774 2048

SPIROL Shim Division
321 Remington Road
Stow, Ohio 44224 U.S.A.
Tel. +1 330 920 3655
Fax. +1 330 920 3659

SPIROL Canada
3103 St. Etienne Boulevard
Windsor, Ontario N8W 5B1 Canada
Tel. +1 519 974 3334
Fax. +1 519 974 6550

SPIROL Mexico
Avenida Avante #250
Parque Industrial Avante Apodaca
Apodaca, N.L. 66607 Mexico
Tel. +52 81 8385 4390
Fax. +52 81 8385 4391

SPIROL Brazil
Rua Mafalda Barnab  Soliane, 134
Comercial Vit ria Martini, Distrito Industrial
CEP 13347-610, Indaiatuba, SP, Brazil
Tel. +55 19 3936 2701
Fax. +55 19 3936 7121

Asia Pacific **SPIROL Asia Headquarters**
1st Floor, Building 22, Plot D9, District D
No. 122 HeDan Road
Wai Gao Qiao Free Trade Zone
Shanghai, China 200131
Tel: +86 (0) 21 5046-1451
Fax: +86 (0) 21 5046-1540

SPIROL Korea
16th Floor, 396 Seocho-daero,
Seocho-gu, Seoul, 06619, South Korea
Tel: +82 (0) 10 9429 1451

e-mail: info-uk@spirol.com